



Features

- Patented Quad Terminal Design - Reduce carrying costs
- 12V VRLA Hi Capacity Starting Battery
- Absorbed Glass Mat (AGM) technology
- Brass Terminals - superior conductivity
- US IATA certified non-spillable
- Highest AH Capacity in the Industry
- Factory Activated-Ready to Install

Performance Specifications

Nominal Voltage ----- 12 volts (6 cells)

Nominal Capacity

20-hr. (1.25A to 10.50 volts)	-----	26AH
10-hr. (2.50A to 10.50 volts)	-----	25.0AH
5-hr. (5.0A to 10.20 volts)	-----	21.3 AH
1C. (25.0A to 9.6 volts)	-----	41Min (16.8AH)
8C. (200A to 6.00 volts)	-----	3Min (10AH)

Approximate Weight ----- 16.1 lbs. (7.30kg)

Energy Density (20-hr. rate) ----- 1.77W-h/in³ (108 W-h/l)

Specific Energy (20-hr. rate) ----- 19.2W-h/lb (42.3 W-h/kg)

Internal Resistance (approx) ----- 14 milliohms

CCA (-0.4°F/-18°C,7.2V,30S)----- 285 amperes

CA (68°F/20°C,7.2V,30S)----- 350 amperes

Shelf Life (% of nominal capacity at 68°F (20°C)----- SOC% OCV

1 Months	-----	97%	12.78V
3 Months	-----	91%	12.7V
6 Months	-----	83%	12.5V

Operating Temperature Range

Charge ----- -4°F(-20°C) to 122°F(50°C)

Discharge ----- -40°F (-40°C) to 140°F(60°C)

Case ----- ABS

Carton Contents ----- 1-MotoBatt MBTX24U Battery,

Fit spacers (1 bottom),4 stainless steel terminal screws, 2 brass terminals, 4mm Allen Wrench, Install / user manual.

Brass Terminals (mm)

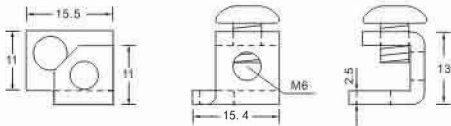

Terminal Screws: Stainless, M6 Thread
Fastener: 4mm Allen Hex

Physical Dimensions: (in./mm)

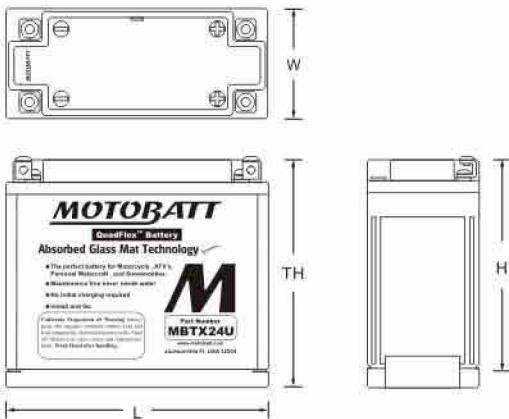

L:8.07(205) W:3.43(87) H:6.38(162)
TH.:6.93(176)

Tolerances are +/-0.04in.(+/-1mm) and +/-0.08in.(+/-2mm) for height dimensions.

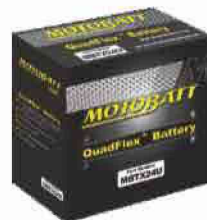

RETAIL CARTON



TERMINAL TERMINAL COVER SCREW WRENCH

Shelf life & Storage

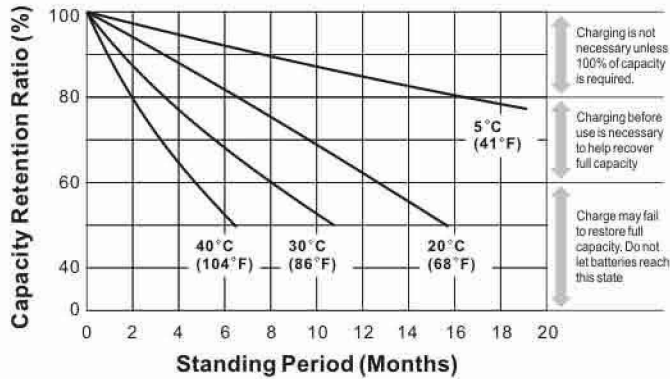

Discharge Characteristics

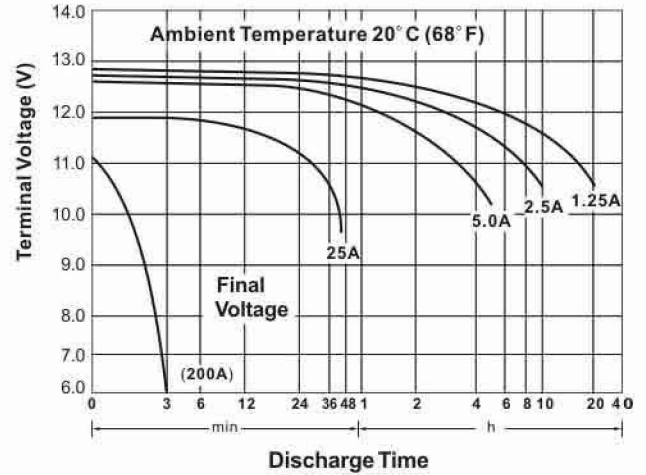

Discharge Time vs. Discharge Current

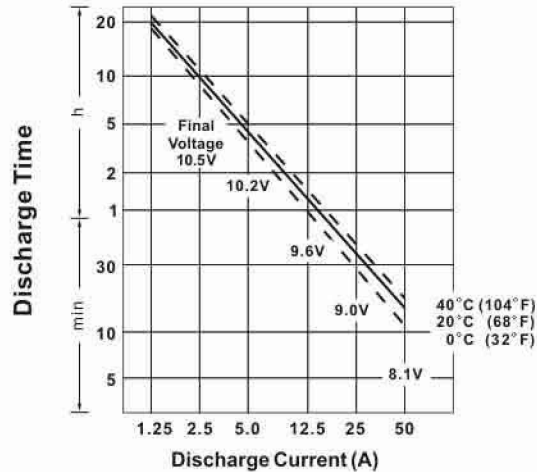

Life Characteristics in Cyclic Use

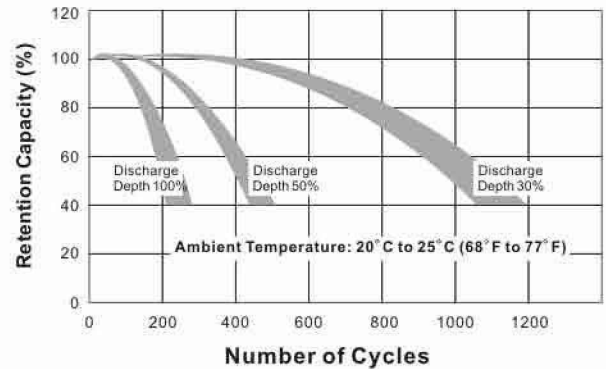

Charging

Cycle Applications: limit initial current to 7.5A. Charge until battery voltage (under charge) reaches 14.8 to 15.0 volts at 68°F (20°C). Hold at 14.8 to 15.0 volts until current drops to under 500mA. Battery is fully charged under these conditions, and charger should be disconnected or switched to "float" voltage.

Note: Due to the self-discharge characteristics of this type of battery, it is imperative that they be charged within 6 months of storage, otherwise permanent loss of capacity might occur as a result of sulfation.

Can be used to replace

12N183	12N183A	Y50N18AA	Y50N18LA
Y50N18LA2	Y50N18LA3	Y50N18LACX	SY50N18LA
SY50N18LAT	YTX24HLBS	YTX24HL	