



**EVX series**

**EVX 12260 12V 26AH**



**Valve Regulated Lead Acid Battery**

Maintenance-Free Sealed Lead Acid Battery.  
Absorbent Glass Mat (AGM) technology for efficient gas recombination of up to 99%.

**Design for Cyclic Applications**

<p><b>【Design Life】</b> 400 cycles @ 100%DOD at 25°C 1800 cycles @ 30%DOD at 25°C</p> <p><b>【Operating Temperature Range】</b> Nominal Operating Temperature : 25°C (77°F) Discharge : -15°C ~ 50°C (5°F~122°F) Charge: -15°C ~ 40°C (5°F~104°F) Storage: -15°C ~ 40°C (5°F~104°F)</p>	<p><b>【Equalization Charging Voltage】</b> 14.4 ~ 15.0 VDC/Unit at 25°C (77°F)</p> <p><b>【Self Discharge】</b> Less than 10% after 90 days, can be stored up to 6 months at 25°C (77°F); Fully recharging is required before usage, and charged sooner if stored at higher temperature than 25°C (77°F).</p>
---	--

**Specification**

Nominal Voltage	12V (6 cells per unit)	
Nominal Capacity	26 AH @20HR-rate to 1.75V per cell @25°C (77°F)	
Weight	Approx. 8.65 Kg (19.06 lbs)	
Maximum Discharge Current	350A (5sec)	
Internal Resistance	Approx. 9.6 mΩ	
Short Circuit Current	--	
Maximum Charge Current	7.80A	
Terminal types	B1/B1B/B3 terminal or I1 terminal to accept M5 bolt	
Terminal hardware Torque	59 Kgf-cm / 51 lbf-in / 5.73 N-m	
Container Material	ABS (UL 94-HB)	
Dimensions	Length (L)	166.0±2.0 mm      6.54±0.08 inch
	Width (W)	175.0±2.0 mm      6.89±0.08 inch
	Container Height (h)	125.0±1.5 mm      4.92±0.06 inch
	Overall Height (H)	125.0±1.5 mm      4.92±0.06 inch

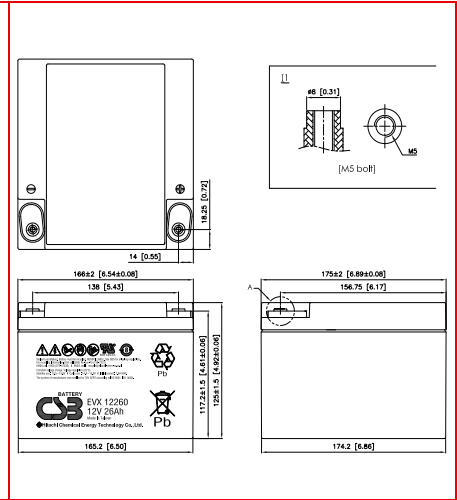

**Constant Current Discharge Characteristics Unit: A (25°C, 77°F)**

F.V/Time	30MIN	45MIN	60MIN	90MIN	2HR	3HR	4HR	5HR	6HR	8HR	10HR	20HR
1.60V	27.3	20.3	16.5	11.8	9.54	7.03	5.66	4.68	4.03	3.18	2.63	1.44
1.67V	26.5	19.7	16.0	11.4	9.22	6.82	5.49	4.56	3.92	3.09	2.56	1.41
1.70V	25.7	19.1	15.5	11.1	8.97	6.59	5.32	4.43	3.81	3.00	2.48	1.37
1.75V	24.9	18.5	15.0	10.8	8.68	6.39	5.16	4.30	3.70	2.91	2.40	1.33
1.80V	24.1	18.0	14.6	10.4	8.41	6.19	5.00	4.16	3.57	2.81	2.32	1.28
1.85V	23.3	17.4	14.1	10.1	8.13	5.99	4.84	4.03	3.46	2.72	2.24	1.24

**Constant Power Discharge Characteristics Unit: W (25°C, 77°F)**

F.V/Time	30MIN	45MIN	60MIN	90MIN	2HR	3HR	4HR	5HR	6HR	8HR	10HR	20HR
1.60V	328	244	198	141	114	84.3	67.9	56.2	48.4	38.2	31.5	17.3
1.67V	318	237	192	137	111	81.4	65.7	54.6	47.0	37.2	30.6	16.9
1.70V	308	229	186	133	107	79.1	63.8	53.2	45.7	36.0	29.7	16.4
1.75V	299	223	181	129	104	76.7	61.9	51.6	44.3	34.9	28.8	15.9
1.80V	289	216	175	125	101	74.3	60.0	49.9	42.9	33.7	27.8	15.4
1.85V	280	209	170	121	97.1	71.9	58.1	48.3	41.5	32.6	26.9	14.9

Please refer to the official site for the latest rating confirmation. URL: [www.csb-battery.com](http://www.csb-battery.com) Issued: 170113

**Sales Offices**

**日立化成能源科技股份有限公司**  
Hitachi Chemical Energy Technology Co., Ltd.

**BUSINESS HEADQUARTERS**  
Tel: +886-2-2880-5600  
Fax: +866-2-2888-3300

**USA OFFICE**  
Tel: +1-817-244-7777 / 1-(800)3-CSB-USA (272872)  
Fax: +1-817-244-4445

**SHENZHEN OFFICE (CHINA)**  
Tel: +86-755-8831-6488, 8831-6775  
Fax: +86-755-8831-6075

**EUROPE (EMEA) OFFICE**  
Tel: +31(0)180-418-140  
Fax: +31(0)180-418-327

**SHANGHAI OFFICE (CHINA)**  
Tel: +86-21-5046-1622, 5046-0833  
Fax: +86-21-5046-1046

**TAIPEI OFFICE**  
Tel: +886-2-2880-5600  
Fax: +866-2-2888-3300

**BEIJING OFFICE (CHINA)**  
Tel: +86-10-5820-5336, 5820-5338  
Fax: +86-10-5820-3053

Recognized under UL 1989, and certified by ISO 9001, 14001.

