



**GP series**

**GP 12340 12V 34AH**



**Valve Regulated Lead Acid Battery**

Maintenance-Free Sealed Lead Acid Battery.  
Absorbent Glass Mat (AGM) technology for efficient gas recombination of up to 99%.

**Design for Standby Power Applications**

<p><b>【Design Life】</b> Up to 5 Years in Standby Service at 25°C Eurobat (20°C) : 3-5 years, Standard Commercial</p> <p><b>【Operating Temperature Range】</b> Nominal Operating Temperature : 25°C (77°F) Discharge : -15°C ~ 50°C (5°F~122°F) Charge: -15°C ~ 40°C (5°F~104°F) Storage: -15°C ~ 40°C (5°F~104°F)</p>	<p><b>【Float Charging Voltage】</b> 13.5 ~ 13.8 VDC/Unit at 25°C (77°F)</p> <p><b>【Equalization Charging Voltage】</b> 14.4 ~ 15.0 VDC/Unit at 25°C (77°F)</p> <p><b>【Self Discharge】</b> Less than 10% after 90 days, can be stored up to 6 months at 25°C (77°F); Fully recharging is required before usage, and charged sooner if stored at higher temperature than 25°C (77°F).</p>
--	---

Specification		Design according with IEC 61056-1/2: 2012	
Nominal Voltage	12V (6 cells per unit)		
Nominal Capacity	34 Ah @20hr-rate to 1.75V per cell @25°C (77°F)		
Weight	Approx. 10.48 Kg (23.10 lbs)		
Maximum Discharge Current	380A (5sec)		
Internal Resistance	Approx. 9.5mΩ		
Short Circuit Current	915A		
Maximum Charge Current	10.20A		
Terminal types	B5 terminal to accept M6 bolt		
Terminal hardware Torque	138.6 Kgf-cr 120.3 lbf-in 13.58 N-m		
Container Material	ABS (UL 94-HB) & Flame Retardant (94-V0) available upon request		
Dimensions	Length (L)	195.6±2.0 mm	7.70±0.08 inch
	Width (W)	130.0±1.5 mm	5.12±0.08 inch
	Container Height (h)	154.8±2.0 mm	6.09±0.08 inch
	Overall Height (H)	178.3±2.0 mm	7.02±0.08 inch

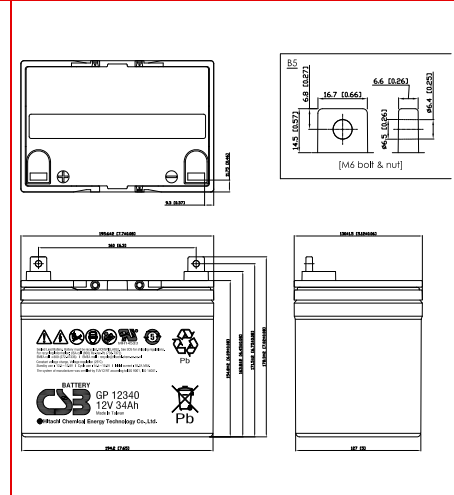

**Constant Current Discharge Characteristics Unit: A (25°C, 77°F)**

F.V/Time	5 MIN	10MIN	15MIN	30MIN	60MIN	90MIN	2HR	3HR	5HR	8HR	10HR	20HR
1.60V	144	91.7	69.3	42.1	25.0	18.2	14.5	10.3	6.55	4.26	3.48	1.86
1.67V	128	85.5	65.5	41.3	24.7	18.0	14.4	10.2	6.50	4.23	3.43	1.78
1.70V	121	82.8	63.8	40.8	24.5	17.9	14.3	10.1	6.49	4.23	3.41	1.75
1.75V	110	77.5	61.2	40.0	24.4	17.8	14.2	10.0	6.47	4.18	3.35	1.69
1.80V	98.0	72.3	58.8	39.2	24.0	17.6	14.1	9.9	6.45	4.14	3.30	1.64
1.85V	86.3	67.0	55.7	38.2	23.6	17.4	14.0	9.8	6.43	4.09	3.24	1.58

**Constant Power Discharge Characteristics Unit: W (25°C, 77°F)**

F.V/Time	5MIN	10MIN	15MIN	30MIN	60MIN	90MIN	2HR	3HR	5HR	8HR	10HR	20HR
1.60V	1732	1100	832	505	300	218	174	124	78.6	51.1	41.7	21.6
1.67V	1539	1026	788	495	297	216	173	123	78.1	50.8	41.1	20.7
1.70V	1456	994	771	490	295	215	172	122	77.9	50.7	40.9	20.3
1.75V	1316	931	739	481	292	213	171	121	77.7	50.2	40.3	19.6
1.80V	1176	867	705	470	288	212	170	120	77.4	49.6	39.6	18.9
1.85V	1036	804	669	458	283	209	169	119	77.2	49.1	39.0	18.2

Please refer to the official site for the latest rating confirmation. URL: [www.csb-battery.com](http://www.csb-battery.com) Issued: 170201

**Sales Offices**  
**日立化成能源科技股份有限公司**  
 Hitachi Chemical Energy Technology Co., Ltd.

**BUSINESS HEADQUARTERS**  
 Tel: +886-2-2880-5600  
 Fax: +866-2-2888-3300

**USA OFFICE**  
 Tel: +1-817-244-7777 / 1-(800)3-CSB-USA (272872)  
 Fax: +1-817-244-4445

**SHENZHEN OFFICE (CHINA)**  
 Tel: +86-755-8831-6488, 8831-6775  
 Fax: +86-755-8831-6075

**EUROPE (EMEA) OFFICE**  
 Tel: +31(0)180-418-140  
 Fax: +31(0)180-418-327

**SHANGHAI OFFICE (CHINA)**  
 Tel: +86-21-5046-1622, 5046-0833  
 Fax: +86-21-5046-1046

**TAIPEI OFFICE**  
 Tel: +886-2-2880-5600  
 Fax: +866-2-2888-3300

**BEIJING OFFICE (CHINA)**  
 Tel: +86-10-5820-5336, 5820-5338  
 Fax: +86-10-5820-3053

