



Features

- Patented Quad Terminal Design - Reduce carrying costs
- 12V VRLA Hi Capacity Starting Battery
- Absorbed Glass Mat (AGM) technology
- Brass Terminals - superior conductivity
- US IATA certified non-spillable
- Highest AH Capacity in the Industry
- Factory Activated-Ready to Install

Performance Specifications

Nominal Voltage ----- 12 volts (6 cells)

Nominal Capacity

20-hr. (0.95A to 10.50 volts)-----	19.6AH
10-hr. (1.9A to 10.50 volts)-----	19.0AH
5-hr. (3.8A to 10.20 volts)-----	16.1AH
1C. (19.0A to 9.6 volts)-----	43Min (13.6AH)
8C. (152A to 6.00 volts)-----	3Min (7.6AH)

Approximate Weight ----- 12.46 lbs. (5.65kg)

Energy Density (20-hr. rate) ----- 1.82W-h/in³(111.2 W-h/l)

Specific Energy (20-hr. rate) ----- 18.88W-h/lb (41.63 W-h/kg)

Internal Resistance (approx) ----- 18 milliohms

CCA (-0.4°F/-18°C, 7.2V,30S)----- 250 amperes

CA (68°F/20°C, 7.2V,30S)----- 310 amperes

Shelf Life (% of nomomal capacity at 68°F (20°C)----- SOC% OCV

1 Months -----	97%	12.78V
3 Months -----	91%	12.7V
6 Months -----	83%	12.5V

Operating Temperature Range

Charge ----- -4°F(-20°C) to 122°F(50°C)
 Discharge ----- -40°F (-40°C) to 140°F(60°C)

Case ----- ABS

Carton Contents ----- 1-MotoBatt MBTX16U Battery,
 4 stainless steel terminal screws, 2 brass terminals, 4mm Allen Wrench, Install / user manual.

Brass Terminals (mm)

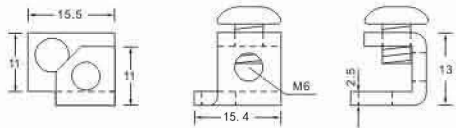

Terminal Screws: Stainless, M6 Thread
 Fastener: 4mm Allen Hex

Physical Dimensions: (in./mm)

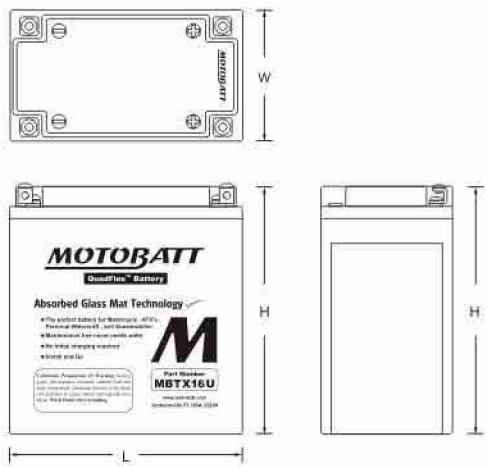

L:5.94(151) W:3.43(87) H:6.34(161)

Tolerances are +/0.04in.(+/1mm) and +/0.08in.(+/2mm) for height dimensions.



RETAIL CARTON



"C" TERMINAL TERMINAL COVER SCREW WRENCH

Shelf life & Storage

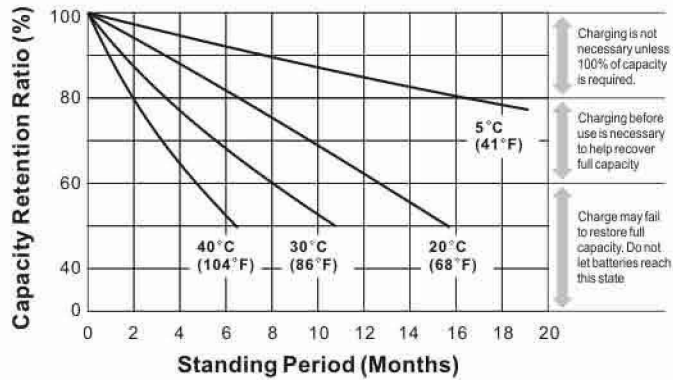

Discharge Characteristics

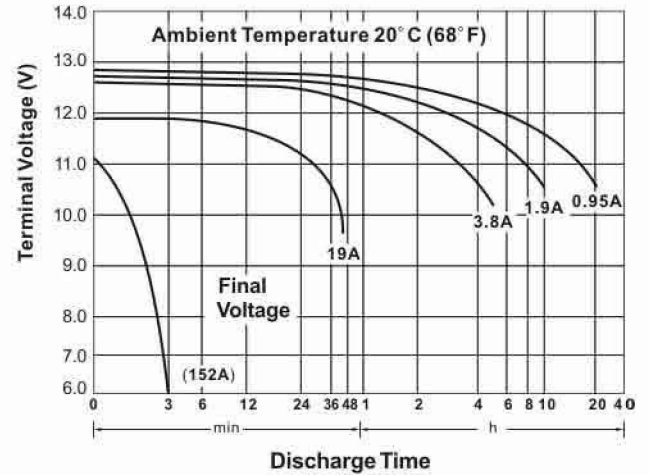

Discharge Time vs. Discharge Current

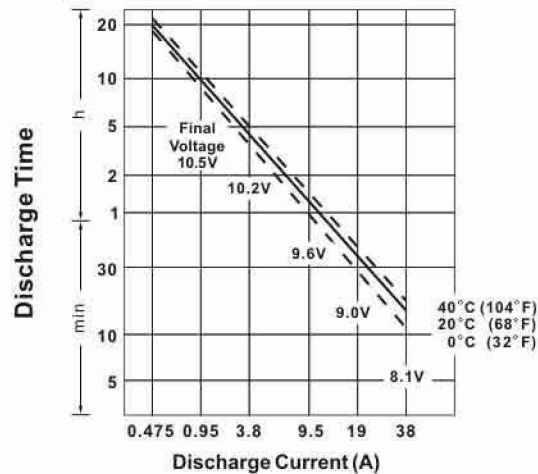

Life Characteristics in Cyclic Use

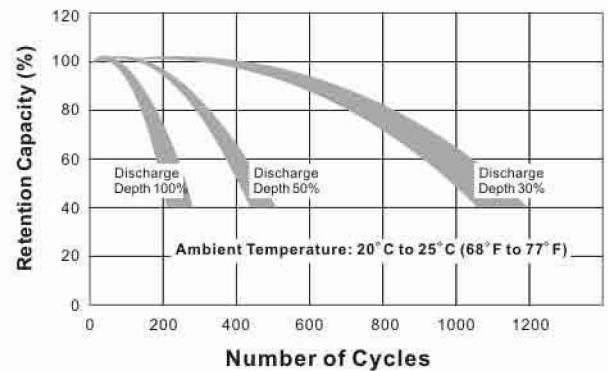

Charging

Cycle Applications: limit initial current to 5.7A. Charge until battery voltage (under charge) reaches 14.8 to 15.0 volts at 68°F (20°C). Hold at 14.8 to 15.0 volts until current drops to under 380mA. Battery is fully charged under these conditions, and charger should be disconnected or switched to "float" voltage.

Note: Due to the self-discharge characteristics of this type of battery, it is imperative that they be charged within 6 months of storage, otherwise permanent loss of capacity might occur as a result of sulfation.

Can be used to replace

YTX16BS	YTX16BS1	YTX20CHBS	