

PR750ELCD/PR1000ELCD
PR1500ELCD

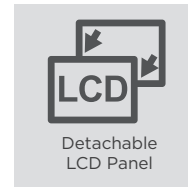

PROFESSIONAL UPS TO SAFEGUARD IT EQUIPMENT

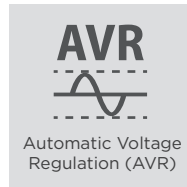
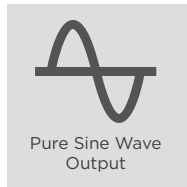
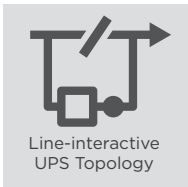

The professional UPS with Automatic Voltage Regulation to stabilize the AC power output for business applications

Designed for computer room and server room applications, the Professional Tower Series adopts line-interactive topology with Automatic Voltage Regulation (AVR) function to offer stabilized AC power output with Pure Sine Wave to ensure high power quality. The UPSs feature hot-swappable battery packs for maintenance without power interruption. The products are also compatible with power management software to easily control and monitor the UPS system.

SERIES FEATURES

- Line-interactive UPS Topology
- Active PFC Compatible
- Automatic Voltage Regulation (AVR)
- Hot-swappable Batteries
- Emergency Power Off (EPO) Port
- SNMP/HTTP Remote Management Capability (Optional)
- Energy Saving Technology
- Pure Sine Wave Output
- Critical/Non-critical Load Outlets*
- Detachable LCD Panel
- USB Connectivity Port
- PowerPanel Management Software

*Selected Model(s)

PRODUCT CALLOUTS

1. Power On Indicator
2. Power On/Off Switch
3. LCD Display Panel
4. Function Button(s)
5. Battery Backup & Surge Protected Outlets
6. AC Inlet
7. SNMP/HTTP Network Slot
8. Input Circuit Breaker
9. USB Port
10. Serial Port
11. EPO Port

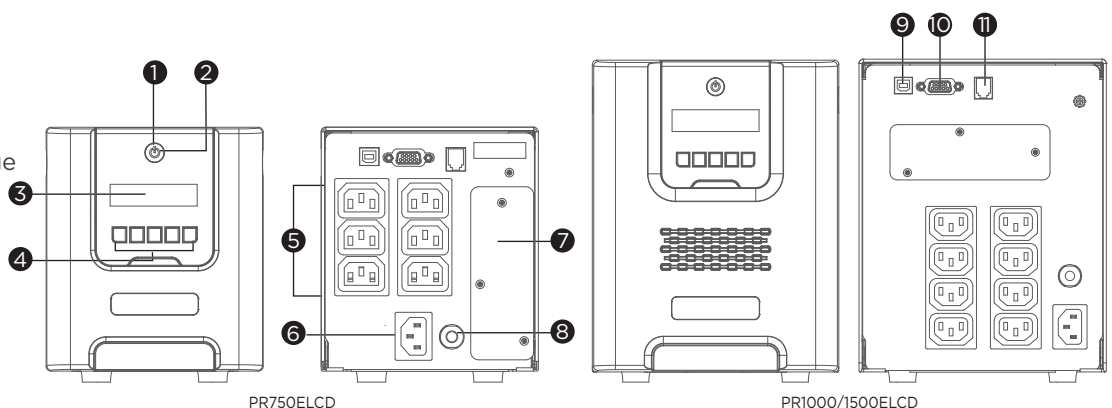



TECHNICAL SPECIFICATIONS

Model Name	PR750ELCD	PR1000ELCD	PR1500ELCD
General			
UPS Topology	Line-interactive		
Energy Saving Technology	GreenPower UPS™ Bypass Technology		
Active PFC Compatibility	Yes		
Input			
Nominal Input Voltage (Vac)	230		
Input Voltage Range (Vac)	151 - 301		
Input Frequency (Hz)	50 ± 3, 60 ± 3		
Input Frequency Detection	Auto-sensing		
Rated Input Current (A)	10		
Input Connector Type	IEC C14		
Output			
Capacity (VA)	750	1000	1500
Capacity (Watts)	675	900	1350
On Battery Waveform	Pure Sine Wave		
On Battery Voltage(s) (Vac)	230 ± 5%		
On Battery Frequency (Hz)	50 ± 1%, 60 ± 1%		
Power Factor	0.9		
Automatic Voltage Regulation (AVR)	Double Boost, Single Buck		
Overload Protection	Internal Current Limiting		
Outlet(s) - Total	6	8	
Outlet Type	IEC C13 x 6	IEC C13 x 8	
Outlet(s) - Battery & Surge Protected	6	8	
Outlet(s) - Critical Load (CL)	-	4	
Outlet(s) - Non-Critical Load (NCL)	-	4	
Typical Transfer Time (ms)	4		
Battery			
Runtime at Half Load (min)	10.5	16	17
Runtime at Full Load (min)	2.5	4	
Typical Recharge Time (Hours)	8		
User-replaceable	Yes		
Hot-swappable	Yes		
Battery Type	Sealed Lead-acid		
Replacement Battery Pack	RBP0014	RBP0106	RBP0023
RBP Quantity (pcs)	1		
Surge Protection & Filtering			
Surge Suppression (Joules)	405		
EMI/RFI Filtration	Yes		
Management & Communications			
LCD Panel	Yes		
LCD Types	Detachable LCD Panel		
HID Compliant USB Port(s)	1		
Serial Port	Combo (RS232 + Dry Contact)		
Emergency Power Off (EPO) Port	Yes		
Power Management Software	PowerPanel Business (Recommended)		
SNMP/HTTP Remote Monitoring	Yes - with optional RMCARD205		
Physical			
Form Factor	Tower		
Physical Size - UPS Module			
Dimensions (WxHxD) (mm.)	136 x 162 x 349	170 x 221 x 432	
Weight (kg.)	12.3	18.9	25.1
Environmental			
Operating Temperature (°C)	0 - 40		
Operating Relative Humidity (Non-condensing) (%)	0 - 95		
Online Thermal Dissipation (BTU/hr)	75	102	113
Certifications			
Certifications*	CE, EAC, RCM		
RoHS	Yes		

*Certifications may vary according to different regions. Visit www.cyberpower.com for more information.
#All specifications are subject to change without notice.