



Yuasa Technical Data Sheet

Yuasa YBX3056 - YBX3000 SMF Batteries

Performance

Voltage	12V
Capacity (20-hour)	36Ah
Cold Cranking Amps (EN1)	330A

Dimensions

Length	187mm
Width	135mm
Height	227mm



Weights & Measures

Mean Weight with Acid	9.3kg
-----------------------	-------

Container Features

Case Type	JIS B19 + B1
Hold Down	B1
State of Charge Indicator	✓
Handles	✓
End Venting	✓
Lid Type	SMF Double Lid

Technology

Flame Arrestor Technology	✓
Separator	Ca/Ca PE
VDA Roll Over Test	✓
Recommended Charge Rate	3A
Performance Marking	W3-C2-V2-E1

Terminal Type

T1/T3

Standard DIN Post

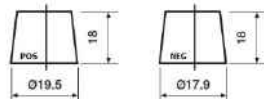

Remove T1 adapter for T3

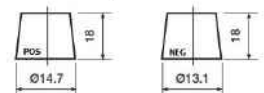

Cell Assembly Layout

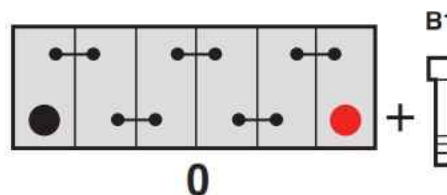

Battery Hold-down

